

CONTEG DATASHEET

CABLE MANAGEMENT

OPTICAL PATHWAY SYSTEM - OptiWay

CONTEG, spol. s r.o.

Czech Republic Headquarters:

Na Vítězné pláni 1719/4
140 00 Prague 4

Tel.: +420 261 219 182

Fax: +420 261 219 192

Production plant in the Czech Republic:

K Silu 2179
393 01 Pelhřimov

Tel.: +420 565 300 300

Fax: +420 565 533 955

Local Branches/Offices

Austria:	+43 170 659 0115
Benelux:	+32 477 957 126
Eastern Europe / Nordics:	+49 172 8484 346
France, Maghreb:	+33 686 074 386
Germany / Switzerland / Baltics / Denmark / Italy:	+49 170 523 4958
India:	+91 99 1695 0773
Middle East:	+971 4445 2838
Russia, CIS:	+7 495 967 3840

conteg@conteg.com

www.conteg.com

OPTICAL PATHWAY SYSTEM - OptiWay

OptiWay is designed to provide a safe easy-to-use and cost-effective management system for your fragile optical cables. OptiWay allows you to route fiber optic cables among equipment and provides the physical protection and bend radius management that is crucial to optical cable performance.

Constructed of halogen-free PC/ABS material, OptiWay can be used to protect your cabling from the point of building entry right up to the terminal devices. The OptiWay system is fully modular, giving you unrivalled flexibility in your chosen layout, whether it's a new-build or refurbishment project.

OPTIWAY



Description of pictures 1 and 2 on the right

No	Code	Description
1	OPW-10DR	Spillover
2	OPW-10IA45-YL	Vertical inside elbow
3	OPW-16MD2M	Main duct
4	OPW-10JO	Joiner
5	OPW-10TP	Trumpet
6	OPW-RRB-100	Threaded rod attachment bracket (rack mounting)
7	OPW-TR-16/20	Threaded rod
8	OPW-TR-BR	Threaded rod mounting bracket
9	OPW-TR-16/100	Threaded rod
10	OPW-30MD2M	Main duct
11	OPW-TRB-30	Threaded rod attachment bracket (ceiling mounting)

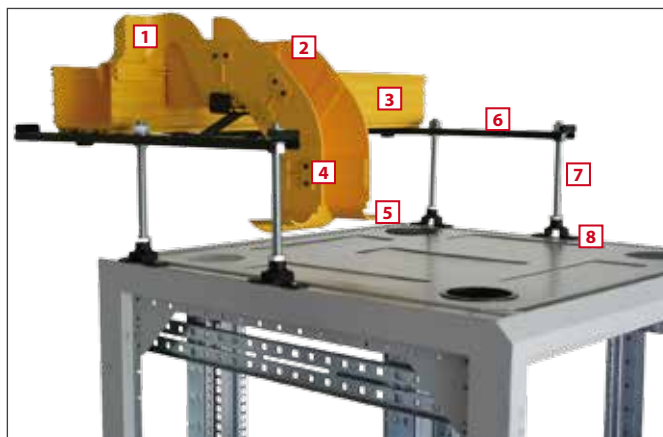

1. Example of OptiWay installation on the top of the rack

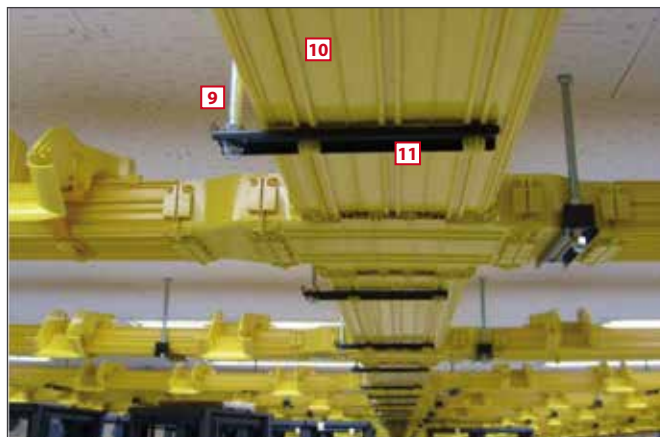

2. Example of OptiWay ceiling installation

OPTIWAY INSTALLATION – there are two ways of installing the OptiWay system. In the first scenario, the threaded rods are fixed to the ceiling and OptiWay ducts are supported by brackets mounted on the threaded rods. In the second scenario, threaded rods are fixed to the top of rack. OptiWay ducts are again supported by brackets mounted on the threaded rods. As each type of installation has its own specific features, the final design is individually customized by Conteg product engineers to guarantee the best available OptiWay system performance.

JOINER

The Joiner is used to connect two components of OptiWay. The joiner does not require drilling of duct or components. Screws included. Color: Yellow

Code	Inner duct size in mm	
	H	W
OPW-10JO-YL	100	100
OPW-16JO-YL	100	160
OPW-30JO-YL	100	300

*for available widths see appropriate table

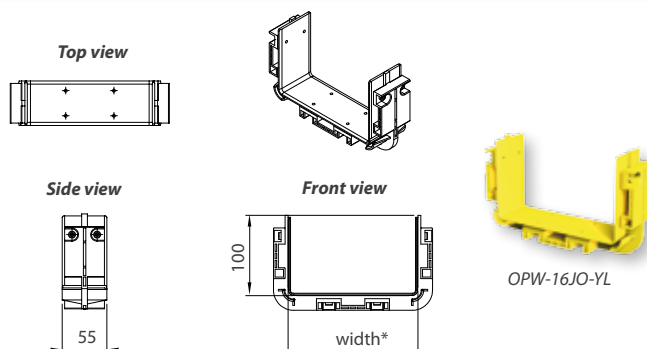

MAIN DUCT

The Main Duct is an extruded 2-meter-long conduit and can be connected with other OptiWay products using joiners. The duct can be easily cut to length on-site. Delivered in even numbers (packaged by 2 pcs = 4 m). Color: Yellow

Code	Inner duct size in mm		Length in m
	H	W	
OPW-16MD2M-YL	100	160	2
OPW-30MD2M-YL	100	300	2
Covers			
OPW-16MD2MC-YL	-	160	2000
OPW-30MD2MC-YL	-	300	2000

Top view



Side view

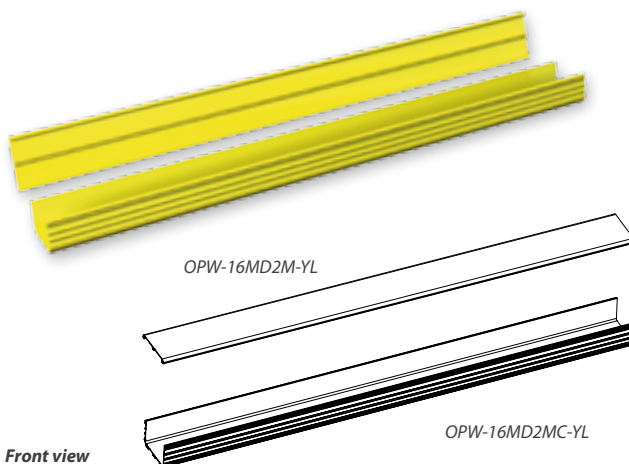
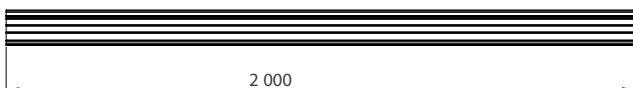

Front view

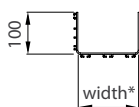

Duct load rating 20 kg/m, required distance between brackets max. 900 mm

*for available widths see appropriate table

CROSS

The Cross is used to establish a 4-way, right-angled intersection. Four joiners are required per cross. Color: Yellow

Code	Inner duct size in mm		Arms
	H	W	
OPW-16CA-YL	100	160	4
OPW-30CA-YL	100	300	4
Covers			
OPW-16CAC-YL			160
OPW-30CAC-YL			300

Top view

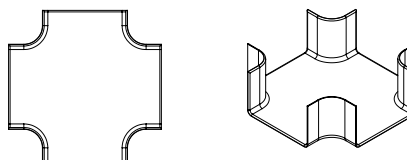

Side view

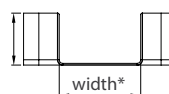

Front view



Cover

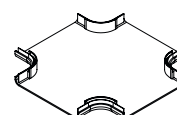

OPW-16CA-YL



OPW-16CAC-YL

*for available widths see appropriate table

REDUCER

The Reducer allows 300×100 mm and 160×100 mm OptiWay sections to be joined together. Two joiners are required per reducer. Color: Yellow

Code	Inner duct size in mm	
	H	W ₁ / W ₂
OPW-3016RD-YL	100	300 / 160
Cover		
OPW-3016RDC-YL	-	300 / 160

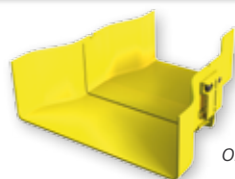

OPW-3016RD-YL

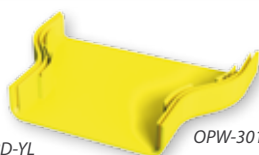

OPW-3016RDC-YL

Top view

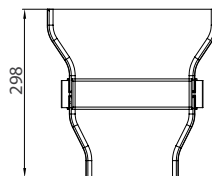

Side view

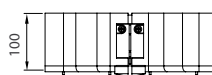

Front view

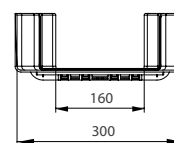

Cover

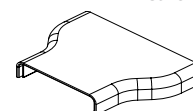

Note: All dimensions in mm

TEE

The Tee is used to establish a 3-way, right-angled intersection. Three joiners are required per Tee. Color: Yellow

Code	Inner duct size in mm	
	H	W
OPW-16TA-YL	100	160
OPW-30TA-YL	100	300
Covers		
OPW-16TAC-YL	-	160
OPW-30TAC-YL	-	300

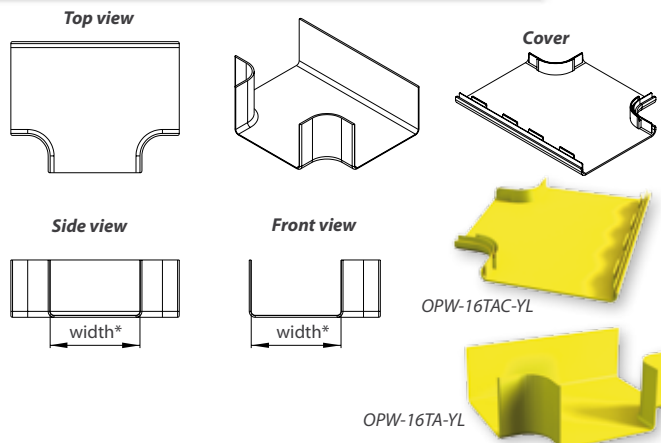

HORIZONTAL ELBOW

The Horizontal Elbows allow ducts to be diverted through 45° or 90°. Two joiners required per elbow. Color: Yellow

Code	Type	Inner duct size in mm	
		H	W
OPW-16HA45-YL	45°	100	160
OPW-30HA45-YL	45°	100	300
OPW-16HA90-YL	90°	100	160
OPW-30HA90-YL	90°	100	300
Covers			
OPW-16HA45C-YL	45°	-	160
OPW-30HA45C-YL	45°	-	300
OPW-16HA90C-YL	90°	-	160
OPW-30HA90C-YL	90°	-	300

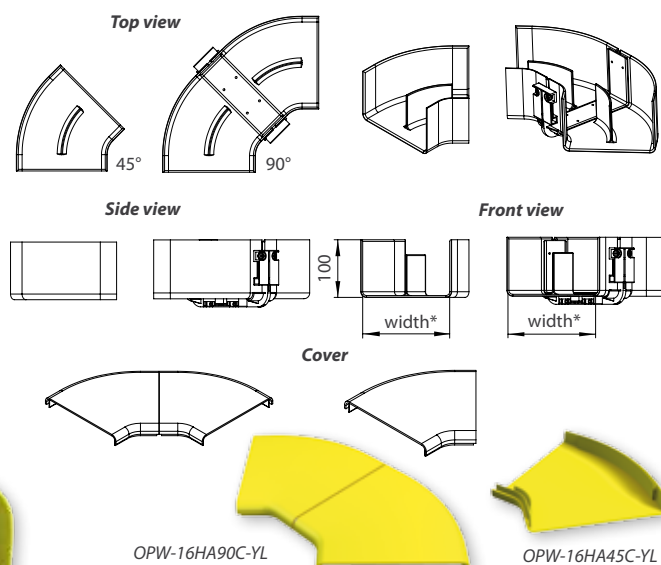

OPW-16HA45-YL

OPW-16HA90-YL

OPW-16HA90C-YL

OPW-16HA45C-YL

*for available widths see appropriate table

VERTICAL INSIDE ELBOW

The Vertical Inside Elbows allow ducts to be diverted through 45° or 90° with an inside angle (usually in a downward direction). Two joiners required per elbow. Color: Yellow

Code	Type	Inner duct size in mm	
		H	W
OPW-16IA45-YL	45°	100	160
OPW-30IA45-YL	45°	100	300
OPW-16IA90-YL	90°	100	160
OPW-30IA90-YL	90°	100	300
Covers			
OPW-16IA45C-YL	45°	-	160
OPW-30IA45C-YL	45°	-	300
OPW-16IA90C-YL	90°	-	160
OPW-30IA90C-YL	90°	-	300

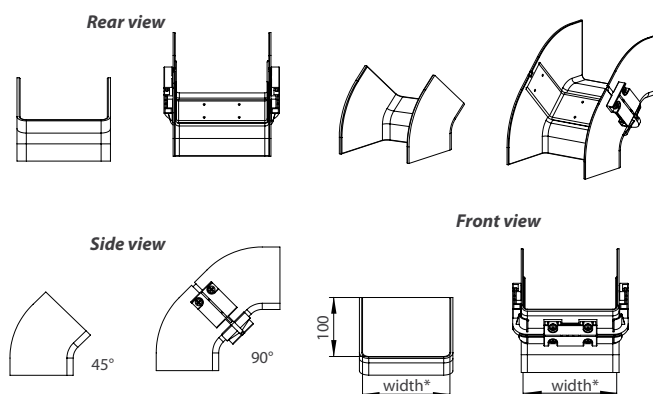

*for available widths see appropriate table

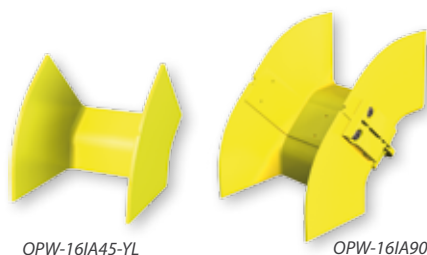

OPW-16IA45-YL

OPW-16IA90-YL

OPW-16IA90C-YL

OPW-16IA45C-YL

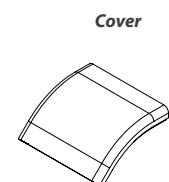

Cover

Note: All dimensions in mm

SPILLOVER

The Spillover is used to provide a protected exit for cables leaving the OptiWay ducting system for cables. Color: Yellow

Code	Inner duct size in mm	
	H	W
OPW-10DR-YL	100	100
OPW-10DRF-YL	100	100
Cover		
OPW-10DRC-YL	-	100
OPW-10DRFC-YL	-	100
ACCESSORIES FOR SPILLOVER		
Code	Description	
OPW-10JO-YL	OptiWay 100 Joiner, 100x100 mm, yellow	
OPW-10TP-YL	OptiWay 100 Trumpet, 100x100 mm, yellow	
OPW-10IA45-YL	OptiWay 100 mm, 45° down angle, yellow	
OPW-SDMB-16	OptiWay Side Drop Mounting Bracket for 160x100 mm duct size	
OPW-SDMB-30	OptiWay Side Drop Mounting Bracket for 300x100 mm duct size	

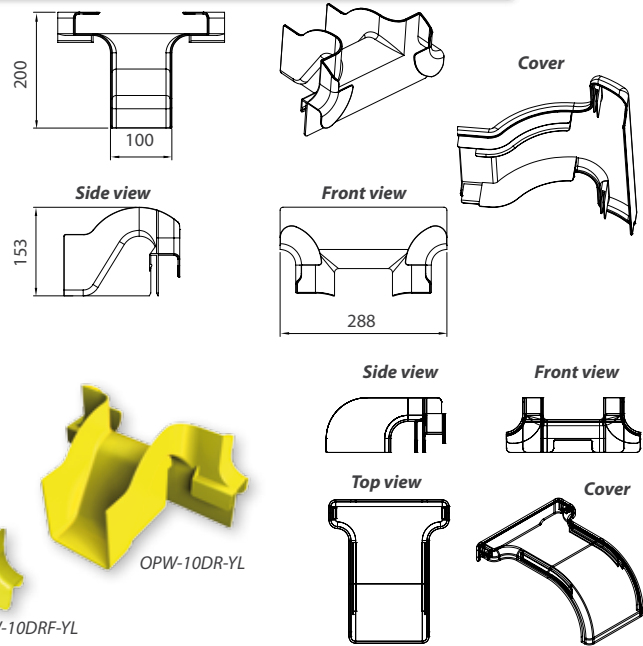
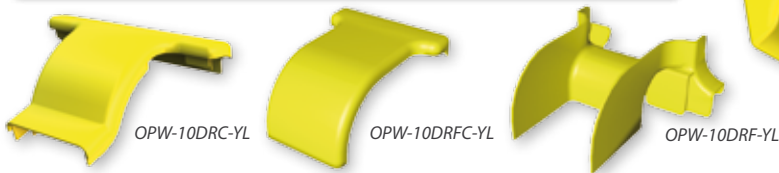

VERTICAL OUTSIDE ELBOW

The Vertical Outside Elbows allow ducts to be diverted through 45° or 90° with an inside angle (usually in an upward direction). Two joiners required per elbow. Color: Yellow

Code	Angle	Inner duct size in mm	
		H	W
OPW-16OA45-YL	45°	100	160
OPW-30OA45-YL	45°	100	300
OPW-16OA90-YL	90°	100	160
OPW-30OA90-YL	90°	100	300
Covers			
OPW-16OA45C-YL	45°	-	160
OPW-30OA45C-YL	45°	-	300
OPW-16OA90C-YL	90°	-	160
OPW-30OA90C-YL	90°	-	300

*for available widths see appropriate table

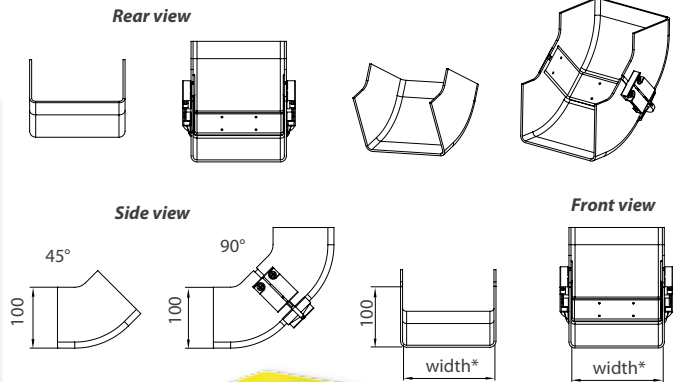
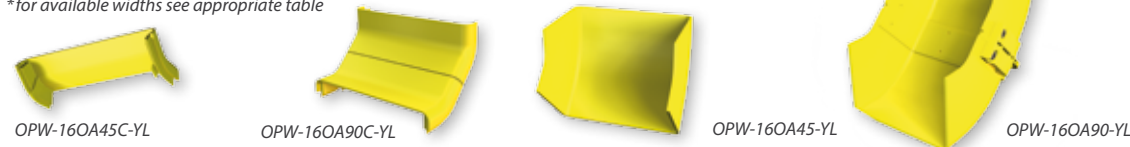

TRUMPET

The Trumpet is used to provide bend-radius control for cables entering or exiting the OptiWay ducting system. One joiner is required per trumpet. Color: Yellow

Code	Inner duct size in mm	
	H	W
OPW-10TP-YL	100	100
OPW-16TP-YL	100	160
OPW-30TP-YL	100	300

*for available widths see appropriate table

END CAP

The End Cap provides a clean finish to the end of an OptiWay run. Color: Yellow

Code	Inner duct size in mm	
	H	W
OPW-16EC-YL	100	160
OPW-30EC-YL	100	300

*for available widths see appropriate table

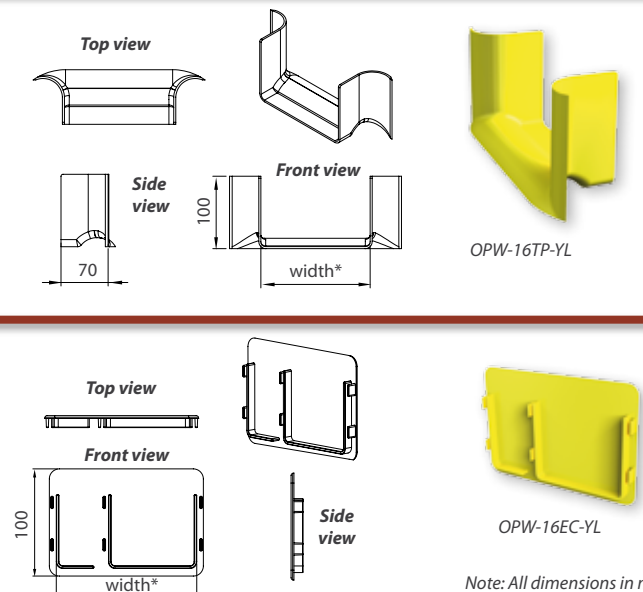

Note: All dimensions in mm

THREADED ROD ATTACHMENT BRACKET

Basic supporting element. Consists of metal bracket and 2 fixing screws. Please note: brackets do not include threaded rod. Recommended 12-16 mm diameter threaded rod. Color: Black

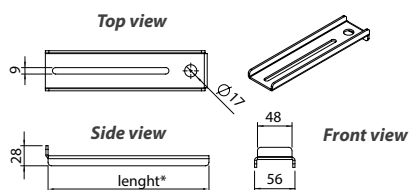

OPW-TRB-16

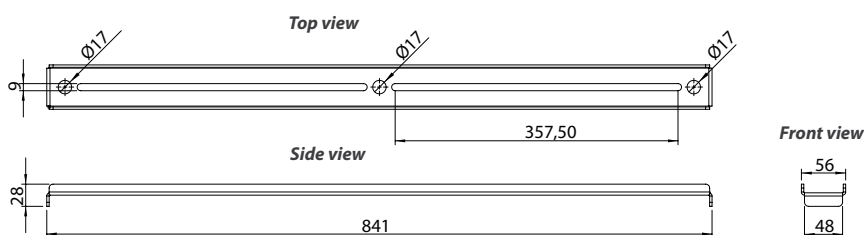

OPW-RRB-100

OPW-SRB-60

Code	Bracket length in mm	Type of mounting	Rec. rack depth in mm	Mount. holes
OPW-TRB-16	160	ceiling mounted	all	1
OPW-TRB-30	300	ceiling mounted	all	1
OPW-RRB-40	400	mounted on the top of the half part of the rack	800	2
OPW-RRB-50	500	mounted on the top of the half part of the rack	1000	2
OPW-RRB-60	600	mounted on the top of the half part of the rack	1200	2
OPW-RRB-80	800	on top of the rack or overlap of the rack	800	3
OPW-RRB-100	1000	on top of the rack or overlap of the rack	1000	3
OPW-RRB-120	1200	on top of the rack or overlap of the rack	1200	3
OPW-SRB-60	600	OptiWay - side mounting bracket for installation of cable duct on a 600 mm wide rack – front/rear orientation	—	2
OPW-SRB-80	800	OptiWay - side mounting bracket for installation of cable duct on a 800 mm wide rack – front/rear orientation	—	2

Note: required distance between brackets RRB max. 900 mm

*for available widths see appropriate table

SPILLOVER SUPPORT BRACKET

Spillover OPW-10DR-YL supporting element. Consists of metal bracket and 2 fixing screws. Color: Black

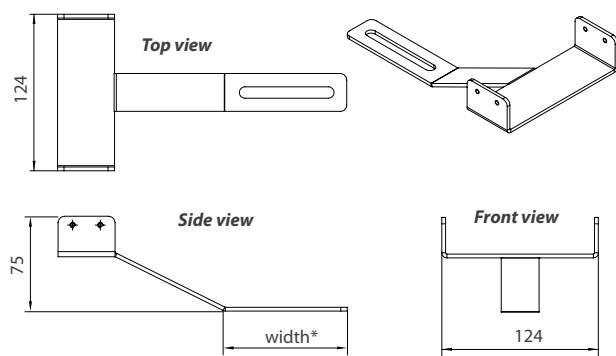

*for available widths see appropriate table

Note: All dimensions in mm

Code	Supported duct inner size in mm	
	H	W
OPW-SDMB-16	100	160
OPW-SDMB-30	100	300

THREADED ROD, MOUNTING BRACKETS

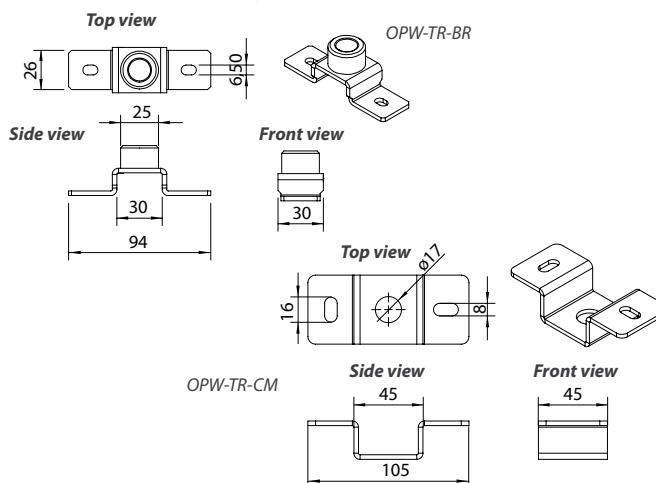

Code	Supported duct inner size in mm		Type of mounting
	H	Size	
OPW-TR-16/100	1000	M16	from the ceiling
OPW-TR-16/200	2000	M16	from the ceiling
OPW-TR-16/20	200	M16	on the top of the rack using OPW-TR-BR
OPW-TR-16/40	400	M16	on the top of the rack using OPW-TR-BR
OPW-TR-16/60	600	M16	on the top of the rack using OPW-TR-BR
OPW-TR-BR		M16	Threaded rod mounting bracket for top part of RDF/RSF/RHF
OPW-TR-CM			Threaded rod mounting bracket for ceiling installation with OPW-TR-16/100 or 200