

DS-1CP0P24-1U

Patch Panel, STP, 1U, 24 Ports, Unloaded Keystone

Key Feature

- High density cold-rolled steel, guarantee mechanical strength.
- Electroplating process, good electrical conductivity.
- Standard grounding wire, ensures shielding grounding.
- Folding bracket, convenient installation, less packing space.
- White silk screen for easy mark.
- Forward extraction design, easy for installation and maintenance.
- Up to 24 ports, install keystone jackets according to the required quantity.
- 1U height, standard structure, high compatibility, easy for working.



Specification

Model	DS-1CP0P24-1U	
Product Type	Patch Panel	
Reference standard	TIA/EIA 568-D,RoHS 2.0	
General Specifications	Cable Type	Shielded
	Color	Black
	Rack Type	EIA 19 inch
	Rack Units	1
	Total Ports, quantity	24
	Keystone quantity	0
Dimensions	Height	44.0 mm
	Width	482.60 mm
	Depth	10.10 mm
	Depth(with bracket)	102.20mm
Material Specifications	Material Type	Cold-Rolled Steel
Environmental Specifications	Flammability Rating	UL 94 V-0
	Operating Temperature	-10 °C to +60 °C
	Storage Temperature	-40 °C to +68 °C
	Relative Humidity	10%~90%RH
Packaging and Weights	Packaging quantity	1
	Packaging Type	Box
	Packaging Dimension	510 x 65 x 77 mm
	Weight	700g

Attachment

Accessory	QTY
Cable Tie	24 pcs
Screw & nut	4 sets
Tool	1 pcs

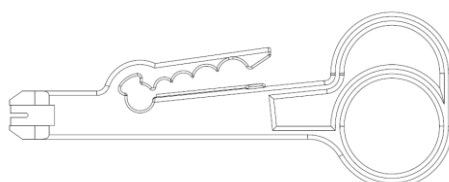
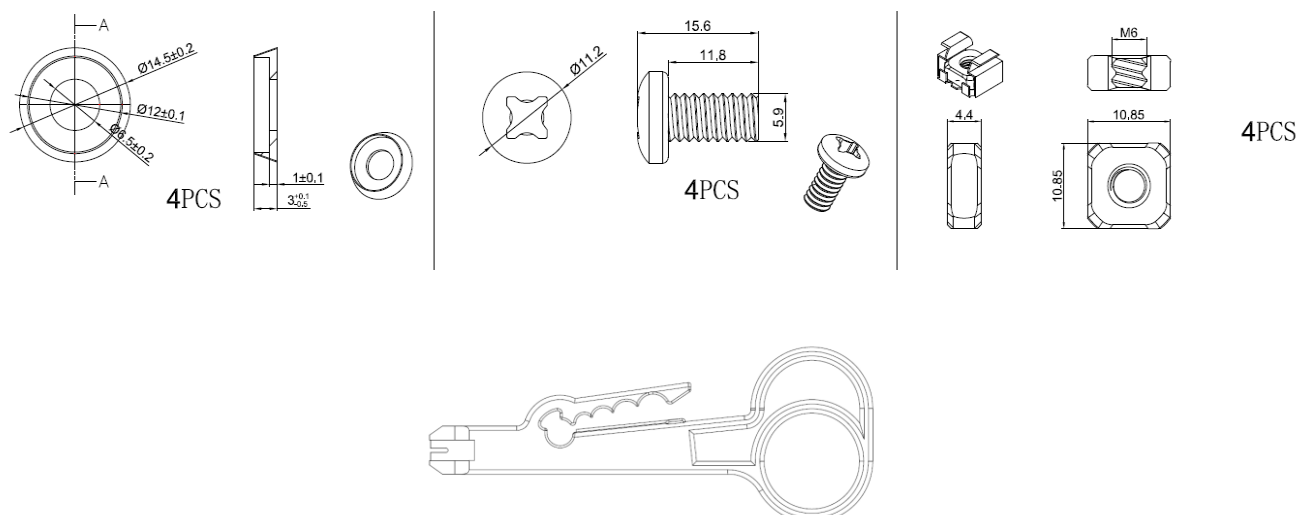
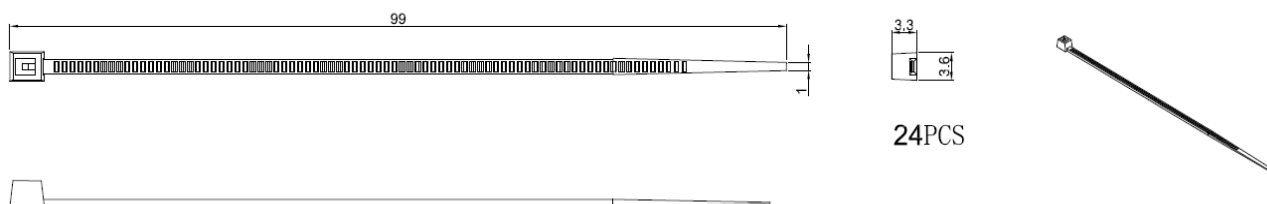

Dimension

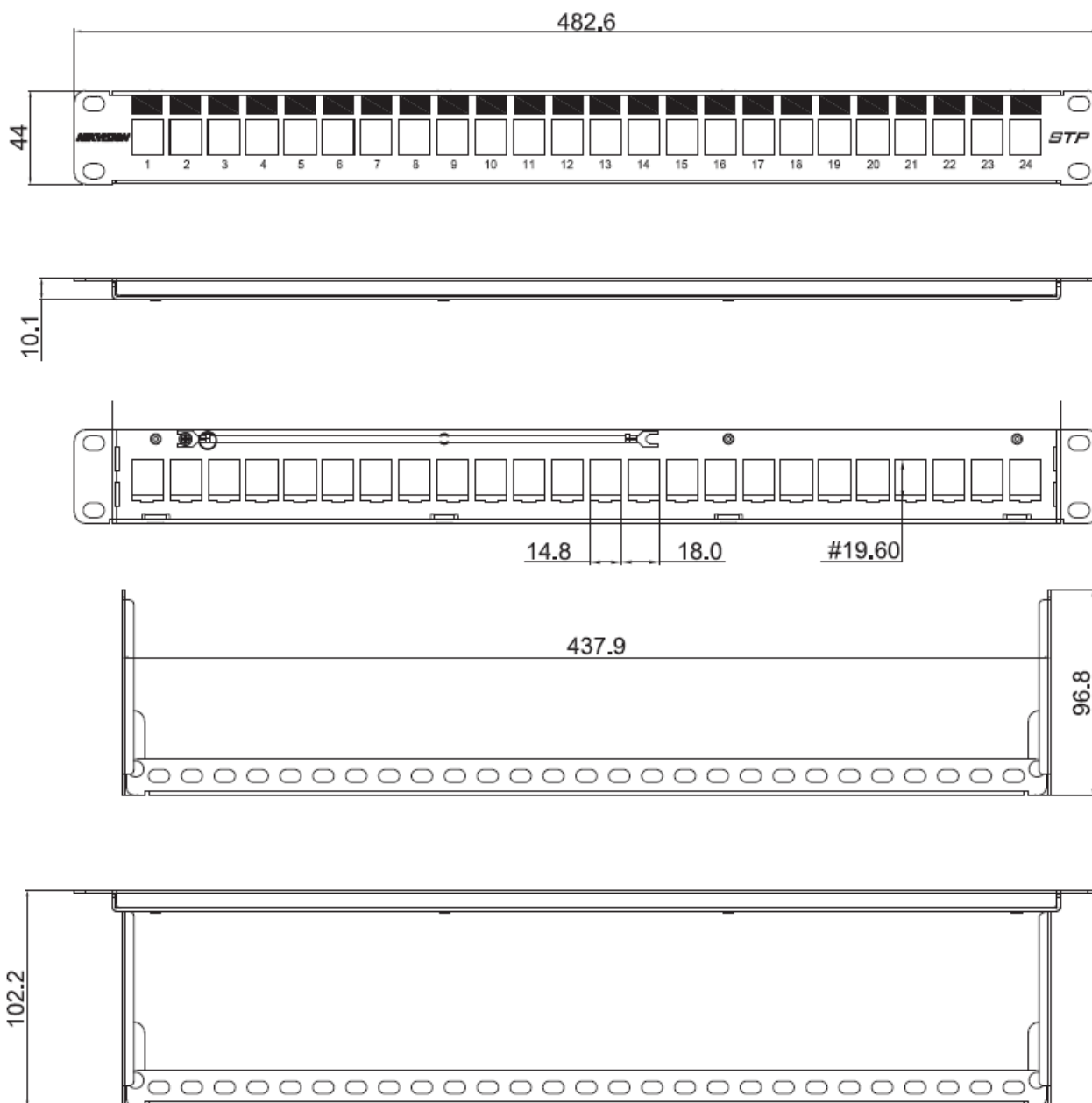

Headquarters

No.555 Qianmo Road, Binjiang District,
Hangzhou 310051, China
T +86-571-8807-5998
www.hikvision.com



Follow us on social media to get the latest product and solution information.

